

Grundfos Cirkulationspumpe med variabel hastighed rustfri stål DN32 flange 10bar 0.91A 230VAC sort/rød WRAS type MAGNA3 32-60FN (220) (7039841)



GRUNDFOS 

TEKNISKE SPECIFIKATIONER

Farve sort/rød

Materiale rustfri stål

Godkendelse WRAS

Pump body rustfri stål

Materiale impeller 1 glasfiberforstærket PES

Tilslutning flange

Volt 230VAC

Maks. temperatur 110 °C

Mindste mellemtemperatur
(kontinuerlig) -10 °C

Antal impeller 1

Frekvens 50 Hz

Maksimal
omgivelsestemperatur 40 °C

Tryk 10 bar

Minimum ambient temperature 0 °C

Type MAGNA3 32-60FN (220)

Størrelse DN32

MWC

6

Ampere

0.91 A

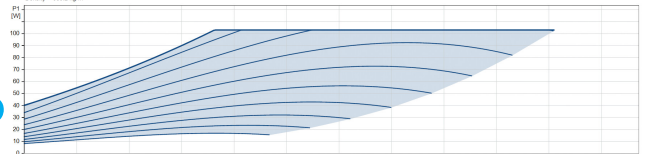
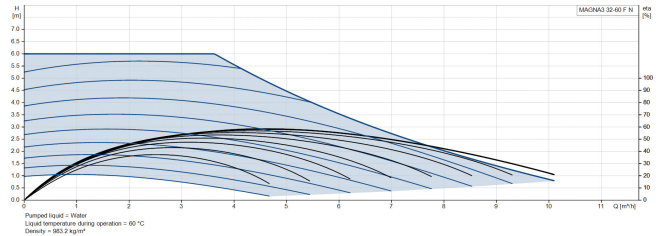
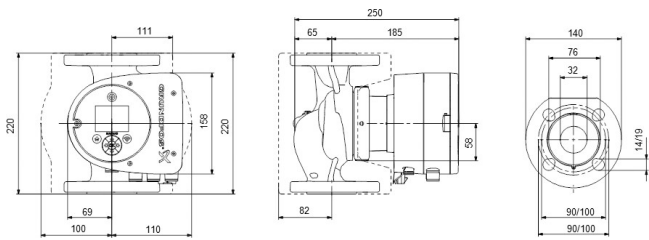

Genereret den: 11-03-2026

Bevo Nordic A/S
Pakhusgården 54
5000 Odense C
Danmark
+45 66 19 25 45
info@bevo.dk
<http://www.bevo.com>